







Apple Cabin + Terrace 5.8H.





Grey

From \$55,000 INC GST

Terrace POA

-  1 bed
-  1 bath
-  1 kitchenette
-  1 terrace (optional)

Specifications

-  Terrace size: 5800 x 2000 x 3200mm
-  Cabin size: 5800 x 3000 x 3200mm
-  Area: 17m²
-  Weight: 3800kg
-  Internal ceiling height: 2700mm

The Apple Terrace 5.8H offers a studio layout with a kitchenette featuring a natural stone benchtop. The bathroom is equipped with a natural stone vanity. Enjoy the convenience of metal fly screens on doors and windows, in addition, the unit has provision for air conditioning and customisable options – ask your sales rep for more information on the options for this unit.

Features:

- Studio layout with a kitchenette featuring a natural stone benchtop
- Spacious bathroom with a natural stone vanity
- Ceilings 2.7m high throughout the unit
- Metal fly screens on doors and windows
- Provision for air-conditioning
- Optional terrace with a full galvanised steel structure and a Perspex ceiling for weather protection
- Durable deck made with eco-boards
- Certified electrical and plumbing
- This unit has customisable options

Apple Cabin + Terrace 5.8H.

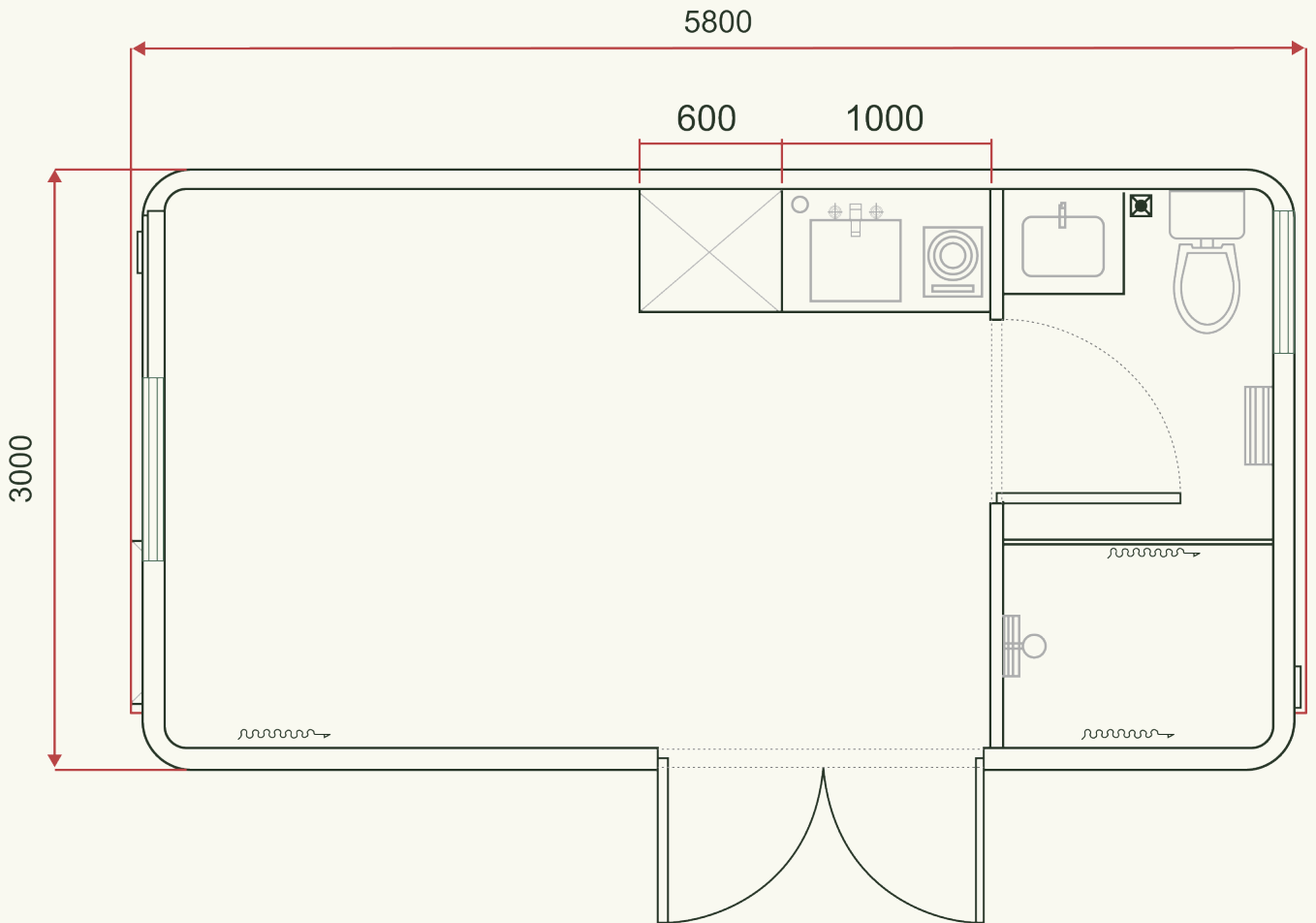

Please note that all images are for illustrative purposes only.
Actual product specifications and inclusions may vary.