



Slide-out 20L.

**Timber look cladding walls
and black frame**

From \$39,600 INC GST

 1 bed

 1 bath

 1 kitchen

Specifications

 Size when opened:
5900 x 4050 x 2550mm

 Size when closed:
5900 x 2260 x 2550mm

 Area: 23m²

 Weight: 2890kg

 Internal ceiling height: 2260mm

The Slide-out 20L features a panoramic glass studio with a kitchenette and overhead cupboards. The bathroom includes a natural stone benchtop, vanity, and a shaving cabinet with space for a washing machine. Enjoy dual entry access, provision for air-conditioning, and a fly screen for added comfort.

Features:

- Panoramic glass studio with kitchenette and overhead cupboards
- Bathroom includes natural stone benchtop and vanity along with a shaving cabinet with provision for a washing machine
- Dual entry access
- Provision for air-conditioning
- Certified electrical and plumbing
- This unit has customisable options

Slide-out 20L.

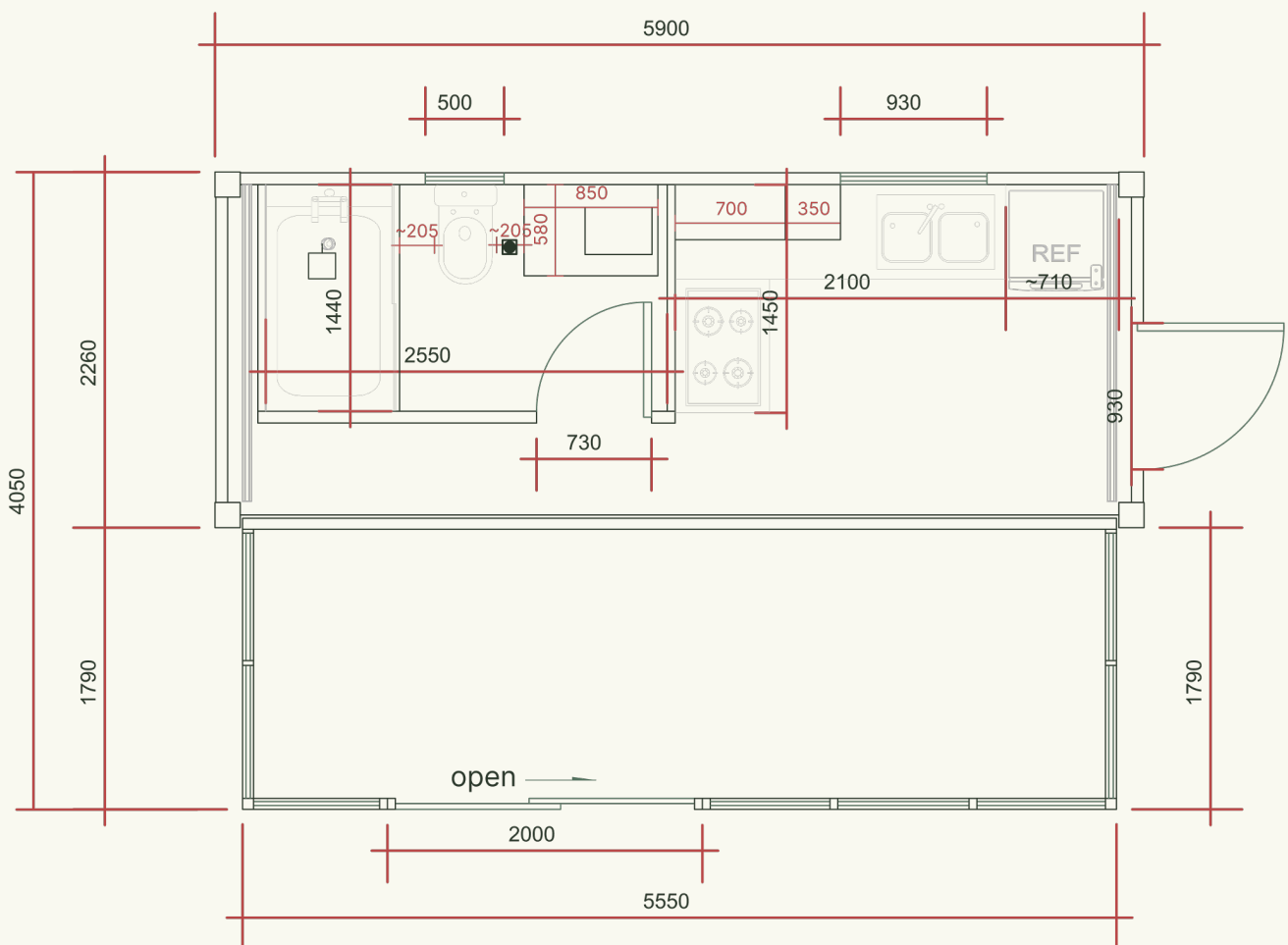

Please note that all images are for illustrative purposes only.
Actual product specifications and inclusions may vary.