



# Nest 30H.

**White wall and black frame**  
**From \$69,500 INC GST**

 2 bed

 1 bath

 1 kitchen

## Specifications

 Size when opened:  
9000 x 6420 x 2770mm

 Size when closed:  
9000 x 2260 x 2770mm

 Area: 57m<sup>2</sup>

 Weight: 6000kg

 Internal ceiling height: 2400mm

The Nest 30H features a versatile two-bedroom layout with a kitchen showcasing natural stone benchtops and overhead cupboards. The bathroom includes a stone vanity, shaving cabinet, and space for a washing machine. Enjoy an open-plan living area, dual entry access, fly screens, and an entry canopy with front lights. A three bedroom version of this model is also available.

### Features:

- Two-bedroom layout
- Kitchen with overhead cupboards and a natural stone benchtop
- Bathroom featuring a natural stone vanity, shaving cabinet, and provision for a washing machine
- Open-plan living area
- Fly screens on most doors and windows
- Dual entry access
- Provision for air-conditioning
- Includes entry canopy and front lights
- Note: This model is also available in a three-bedroom option.
- Certified electrical and plumbing
- This unit has customisable options

# Nest 30H.

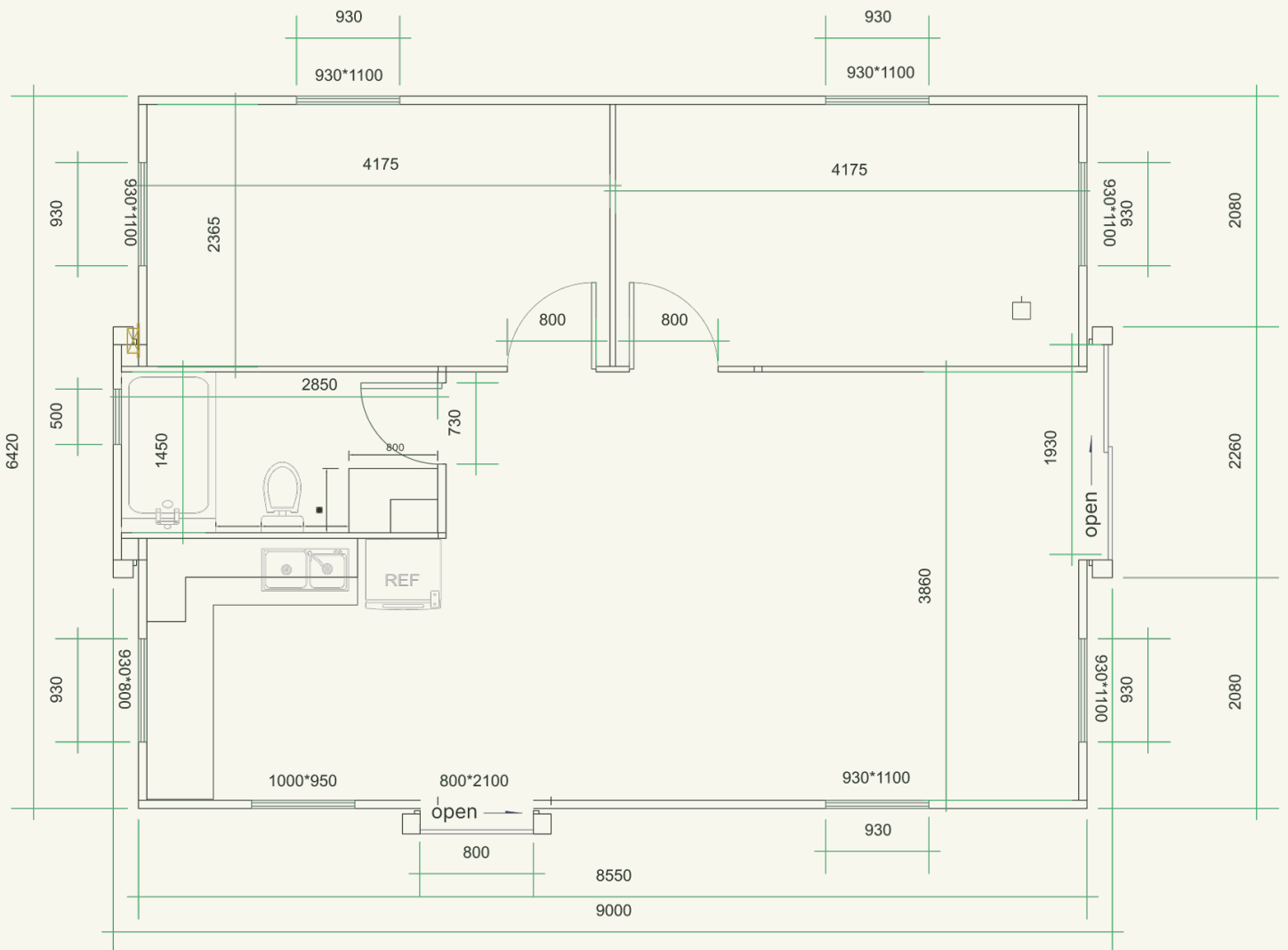

Please note that all images are for illustrative purposes only.  
Actual product specifications and inclusions may vary.